

C26057



PURPOSE: PRIMARY COMMUNITY  MAP REF: 6628/32/N  LAST PLAN: F53738		AREA NAME: HOPE VALLEY  COUNCIL: CITY OF TEA TREE GULLY  DEVELOPMENT NO: 070/C098/09/001/24240 070/C102/10/001/34915		APPROVED:  22/5/2013  DEPOSITED/FILED: 5.10.2010 		<div style="font-size: 2em; font-weight: bold; margin: 0;">C26057</div> <div style="margin: 10px 0;">SUBSTITUTE SHEET</div> <div style="margin: 0;">SHEET 1 OF 2</div> <div style="margin-top: 10px;">V02</div>			
AGENT DETAILS: SAWLEY LOCK O'CALLAGHAN 176 PROSPECT ROAD PROSPECT 5082 PHONE 8344 1522 FAX 8344 1588  AGENT CODE: SLAA REFERENCE: 1328104 MJS		SURVEYORS CERTIFICATION:		I, DAMIAN JOHN BROGDEN a licensed surveyor under the Survey Act 1992, certify that - (a) I am uncertain about the location of that part of the service infrastructure shown between the points marked > and < on the plan; and (b) this community plan has been correctly prepared in accordance with the Community Titles Act 1996. Dated the 8th day of April 2013 Licensed Surveyor					
SUBJECT TITLE DETAILS:									
PREFIX	VOLUME	FOLIO	OTHER	PARCEL	NUMBER	PLAN	NUMBER HUNDRED / IA / DIVISION	TOWN	REFERENCE NUMBER
CT	5656	972		ALLOTMENT(S)	45	D	6074 YATALA		
CT	5829	993		ALLOTMENT(S)	46	D	6074 YATALA		
OTHER TITLES AFFECTED: C'sT 6066/45 TO 50 INCLUSIVE									
EASEMENT DETAILS:									
STATUS	LAND BURDENED	FORM	CATEGORY	IDENTIFIER	PURPOSE	IN FAVOUR OF	CREATION		
ANNOTATIONS: THE COMMON PROPERTY IS DESIGNATED (C1) FOR LAND INFORMATION PURPOSES ONLY AND DOES NOT PROVIDE A LEGAL IDENTIFIER FOR THE COMMON PROPERTY THE SERVICE INFRASTRUCTURE WAS NOT IN PLACE AS AT 8/4/13									

# LOCATION PLAN

# C26057

SHEET 2 OF 2

V02



BEARING DATUM: (1)-(2) 264°40'40"

DERIVATION: F53738

TOTAL AREA: 1827m²

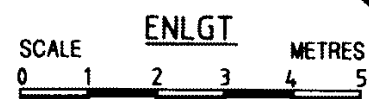
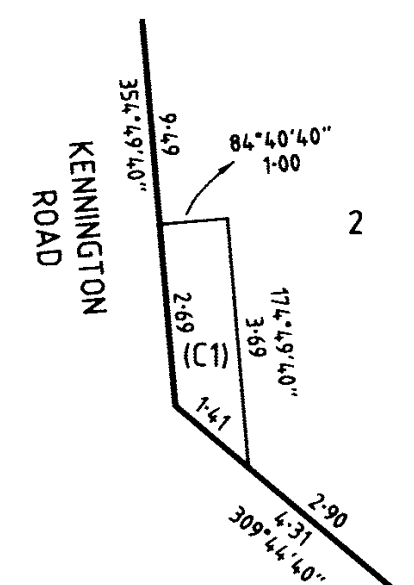
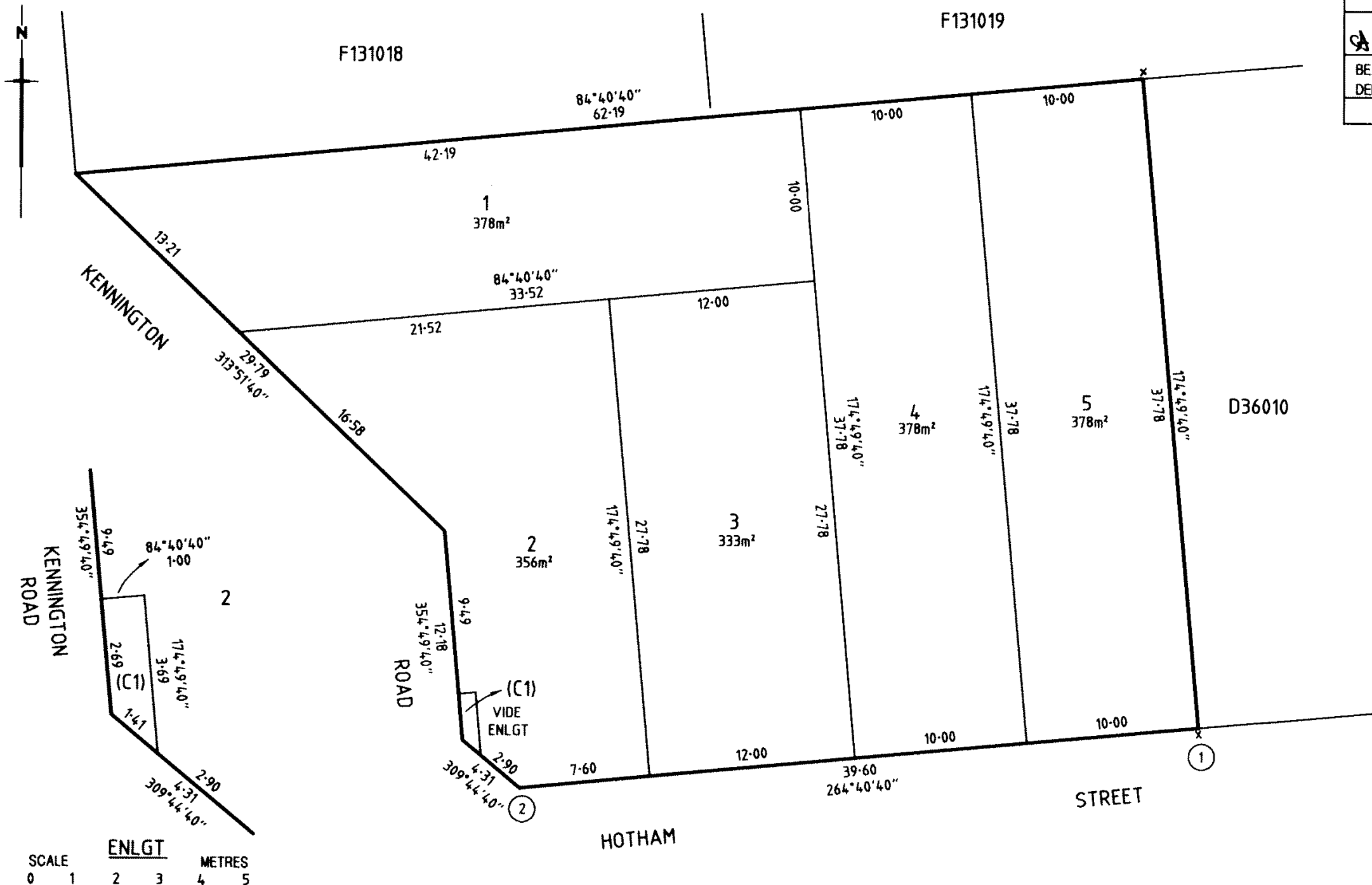

**sawley lock o'callaghan**

licensed surveyors spatial information consultants  
 45 helen street 176 prospect road  
 po box 289 prospect sa 5082  
 mount gambier sa 5290 phone 08 8344 1522  
 phone 08 8725 8422 fax 08 8344 1588  
 fax 08 8725 7361 Refer: 1328104 MJS  
 Revision 2

SUBSTITUTE SHEET

# LOT ENTITLEMENT SHEET

# SUBSTITUTE SHEET

COMMUNITY PLAN NUMBER

**C26057**

SHEET 1 OF 1

ACCEPTED 27 AUG 2013

*[Signature]*  
REGISTRAR-GENERAL

DEV. No 070 : C098 : 09  
070 : C102 : 10

APPLICATION  
ACT 11459438  
AP 11983082

SCHEDULE OF LOT ENTITLEMENTS		
LOT	LOT ENTITLEMENT	SUBDIVIDED
1	2050	
2	2000	
3	1850	
4	2050	
5	2050	
AGGREGATE	10000	

## CERTIFICATE OF LAND VALUER

I Timothy Alder being  
a land valuer within the meaning of the Land Valuers Act 1994  
certify that this schedule is correct for the purposes of the  
Community Titles act 1996.

Dated the 16th day of April 2013

*[Signature]*  
Signature of land valuer